

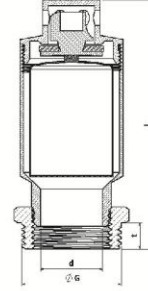

## VANTUZ

### VANTUZ



PARÇA ADI	PART DESCRIPTION	MALZEME	MATERIAL
Gövde	Body	MS 58 Pirinç (CuZn39Pb2)	MS 58 Brass (CuZn39Pb2)
Valf	Valve	MS 58 Pirinç (CuZn39Pb2)	MS 58 Pirinç (CuZn39Pb2)
Kapak	Lid	MS 58 Pirinç (CuZn39Pb2)	MS 58 Pirinç (CuZn39Pb2)

ANMA ÖLÇÜSÜ NOMINAL SIZE	d (mm)	G (mm)	L (mm)
1"	22	25	105
1 1/4"	28	32	110
1 1/2"	36	40	110
2"	46	50	110

• ISO 9001 Kalite Sistem Sertifikası. (ISO 9001 Quality System Management) • ISO 228 Dişi X Dişi bağlantı. (ISO 228 Female by Female thread.) • Sıcaklık -10 °C + 50 °C (-10 °C + 50 °C)

## HORTUM RAKORU

### HOSE FITTING

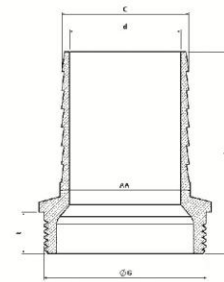

PARÇA ADI	PART DESCRIPTION	MALZEME	MATERIAL
Gövde	Body	MS 58 Pirinç (CuZn39Pb2)	MS 58 Brass (CuZn39Pb2)

ANMA ÖLÇÜSÜ NOMINAL SIZE	C (mm)	AA (mm)	L (mm)
1/2"	16	19	36
3/4"	20	22	41
1"	26	30	45
1 1/4"	32	33	51
1 1/2"	38	43	57
2"	51	55	64
2 1/2"	63	70	76
3"	76	82	82
4"	101	111	100

• ISO 9001 Kalite Sistem Sertifikası. (ISO 9001 Quality System Management) • ISO 228 Dişi X Dişi bağlantı. (ISO 228 Female by Female thread.) • Sıcaklık -10 °C + 120 °C (-10 °C + 120 °C)